



Client: JTD Building Supplies
Sector: Residential

Challenge

To design a front and rear garden which showcased this new build property and addressed the various issues relating to the near 40° slope to the rear of the site, transforming the area into a useable outdoor space.

Issues presented by the topography and ground conditions included but not limited to, drainage of poor ground, retention of the banking, terracing, access, usability, planting selection and specification.

Solution

- Identify and propose options for retaining walls solutions using Marshalls RediRock system
- Specify land drainage and a 'Perfect Manhole' solution
- Carry out a full evaluation of the customer's requirements for use of the space, (working through RIBA stages 1-4)
- Present design options at each stage of the design in a range of formats, including an immersive virtual fly through
- Suggest a range of products and designs to match the aesthetics of the house build
- Research and source planting and provide tree and planting plans

Outcome

- Customer satisfaction from design stage through to delivery, removing the stress from a complexed garden build

"This build has taken over three years now. Johanna from Marshalls has been magnificent throughout. We were wowed with the flyover and the design, it was the first time we had seen the potential, in fact we didn't change a thing. We couldn't be happier with the Marshalls Registered installer that was recommended - Brighthouse Driveways. From start to finish (almost finished) it has been like having the Pro's in. I would like to say a huge thank you to Johanna and the team at Marshalls for the vision and delivery on this project".

Client feedback.

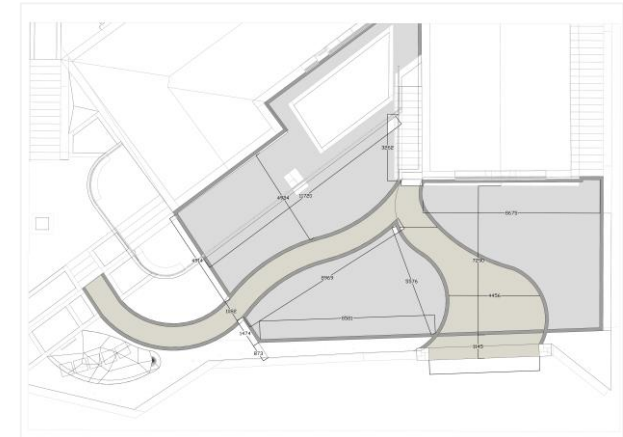
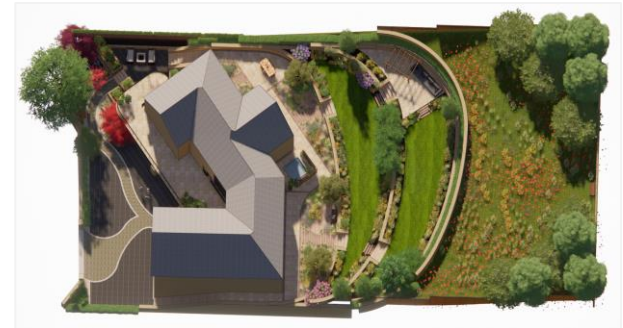

Design & Engineering – Case study

Bespoke Residential Property

