

Marshalls Design Team

Marshalls Natural Stone has led design and innovation in the stone landscaping industry, constantly updating and increasing the services we can offer to our customers. If involved at an early stage, we are confident that we can add value by offering sound design advice which could reduce costs and potential construction problems and also help design in durability and longevity to any scheme. With stone specialists in all areas of the country Marshalls will be delighted to visit and discuss your scheme requirements at any time.

Our multi-talented design team can also help with Drainage designs and other solutions for your hard landscaped areas. We are leaders in SUDs designs, with a range of solutions and products which are second to none. Our designers can also produce structural designs based on the strengths of our stone and the loading criteria. We can also help with layouts, designs and schematics.

For more information or assistance please contact our Natural Stone sales office on 08704 112266 or e-mail us at natstone.sales@Marshalls.co.uk



Marshalls Design Department

The Bespoke Natural Stone Option

DESIGN

Sourcing

Marshalls has the largest range of indigenous and imported stones from around the world but it doesn't end there. There is much more than we could show in this brochure so if you have more specialist requirements then just call us to discuss.

CPDs & Presentations

We have a wide range of CPDs on natural stone, highlighting issues associated with its use, and can produce bespoke presentations tailored to your needs. We can also help with public consultations and bids using our vast library of images and product knowledge.

Design Thicknesses and Laying

Marshalls specialists can provide details of thickness in relation to the individual stone strengths and give advice on how to lay stone to achieve the best results.

TENDERS

General Designs

Marshalls often help designers to make their designs more durable, economical or easier to construct. We can help you with your design or in the most complex cases do the designs for you. You don't need to be a stone expert that's where we come in with our own in house design team and stone specialists who know our stones and what they can do. Marshalls can also check any designs in our stone for compliance with the British standards for selection and installation.

3D Modelling

In some cases it is essential for a scheme or stone element to be modelled in 3 dimensions to ensure its accuracy or assess the design properly. If this does prove necessary then Marshalls has the design team capacity and capability to do this complex work on just about any scheme our stone is used on.

Specifications

Stones cannot be re-engineered so their suitability for any application needs to be carefully considered. We can help ensure that stones used in your specification are fit for purpose and correctly specified.

Bills of Quantities

If the Bill of Quantities is not clear, pricing becomes difficult and may lead to pricing of an inappropriate stone for the scheme. Marshalls can also provide help with Bill of Quantity clauses.

ON SITE

Component Design

When the general design is finished then that's when the detailing begins. Our design team know how stone is manufactured and how to produce the best results. We can detail our stones for all the individual elements to ensure efficient production and quality components.

Production services

Time on site is money - when timescales are tight, Marshalls can help with lead times, prioritising production and stocking to match short construction periods or quick start dates.

CDM regulations

Stone is very often made to bespoke designs, and pieces may be heavy or eccentric in weight and profiling, making conventional handling techniques impossible. We can advise on weights, help with handling techniques and package units in a construction-friendly way.

Hebden Bridge

These elegant, wave-like Yorkstone steps were designed by the client to enhance a local riverside area providing access to the river and also a seating area for the many river-based public events. The symmetrical design allowed a repetition of the pieces required, which speeded up production by allowing the batching of shapes on our profiling saws. The shape was first broken down into the individual step requirements and then single component drawings which made allowance for joints and construction method. Landscape design which not only looks great but was also relatively easy to produce. Elegance and simplicity achieved through good design.

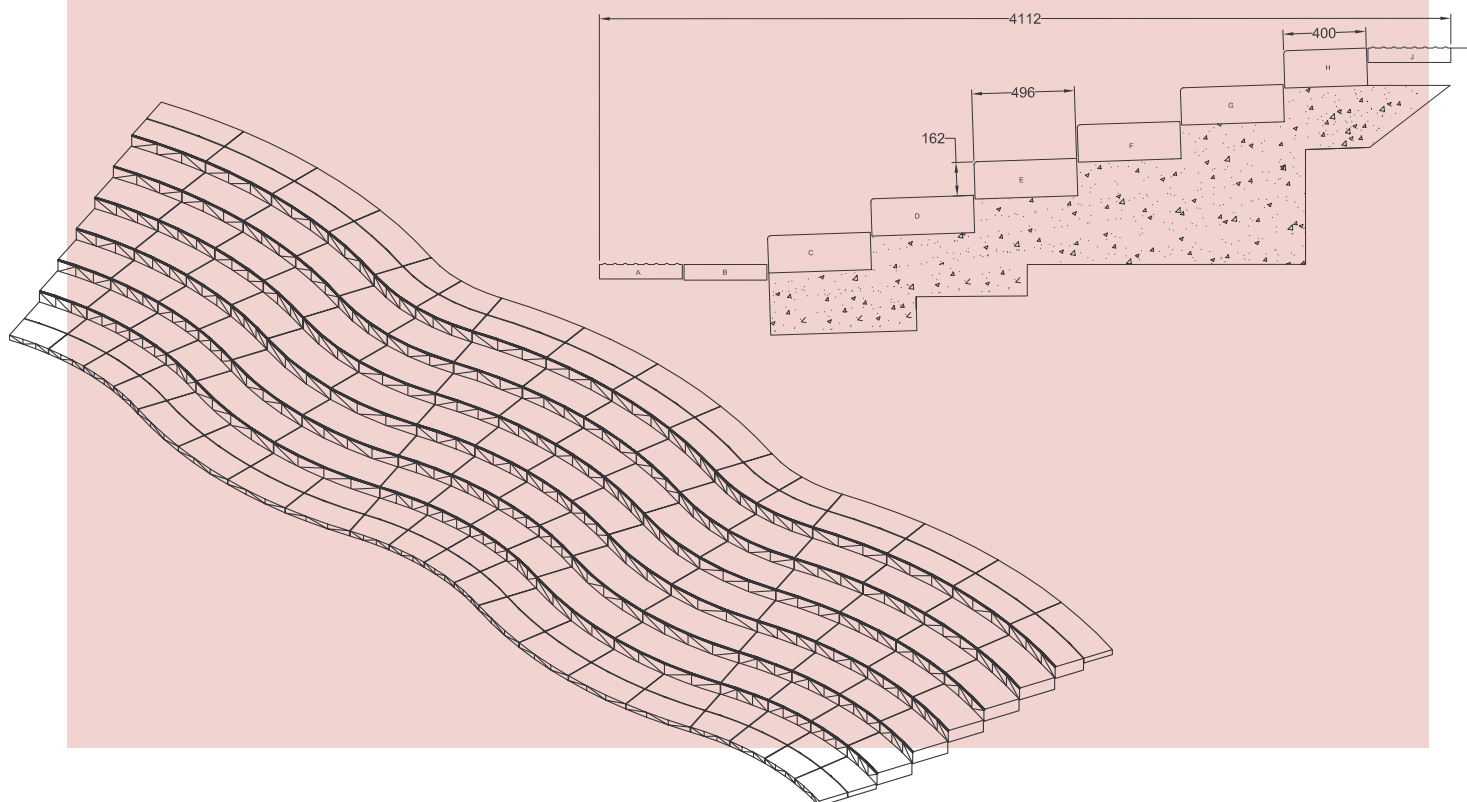
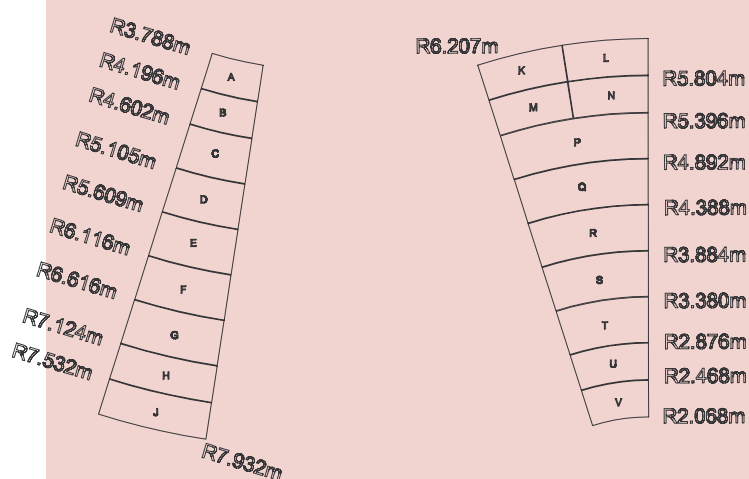
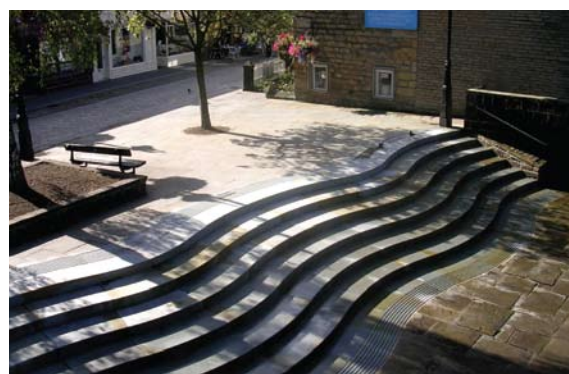



Pier Head Liverpool

A unique scheme made up of 32 individually designed irregular shaped walls and staircases, forming an amphitheatre and also seating areas in one of Britain's largest and most recognisable public squares. Incorporating the Leeds Liverpool canal extension through to the Albert Dock, this remarkable space boasts canal walls with a specially selected hand tooled finish, specialist designed and profiled copings and clever wraparound curved bridge parapet cladding.

Generally with just plan and level drawings Marshalls designed, detailed and scheduled the components on one of the most intricate landscape schemes ever undertaken in the UK, all to the approval of the architect and engineer and all shipped in order of construction sequence for the contractor. The designs had to incorporate embossed anti-skate details and flush fit lighting features, with solid pieces turning seamlessly into cladding and coping pieces. Seats transition into steps and walls curve up or down to run seamlessly into the constantly changing ground levels.

This is an incredibly complex and ambitious scheme which challenged all those involved through its inception, design and construction. It is simply one of the best pieces of modern landscape architecture to be seen in the UK.

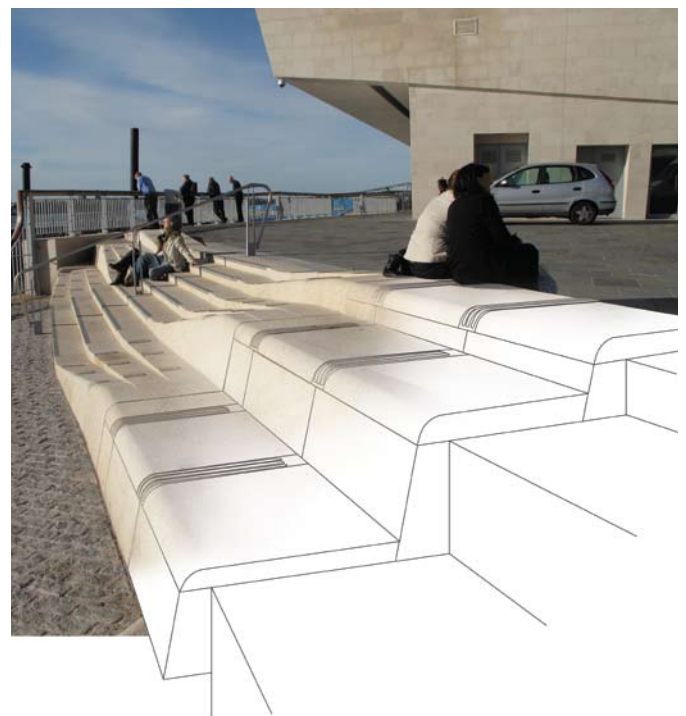

Manchester Arndale

The compact and curved nature of the new ramped entrance to the Arndale Centre extension in Manchester posed some difficult design issues. These were caused by the variation in height at all points of both the top of the wall and the ground level, coupled with the outer curved wall being made up of three separate interlocking radii. Marshalls design team modelled the whole of the ramp structure in 3-D so that an assessment of the shape could be made. This modelling allowed Marshalls to assess not only the individual shapes required but also the quantity of stone which was actually seen so that the minimum of Yorkstone cladding could be manufactured.

This assessment not only saved the client money by enabling the use of cheaper materials below ground but also speeded up the construction time as the number of difficult pieces required was reduced to a minimum. The order was therefore quicker to complete in the factory and also to fix on site, as well as reducing the number of structural fixings. Difficult shapes made simpler.

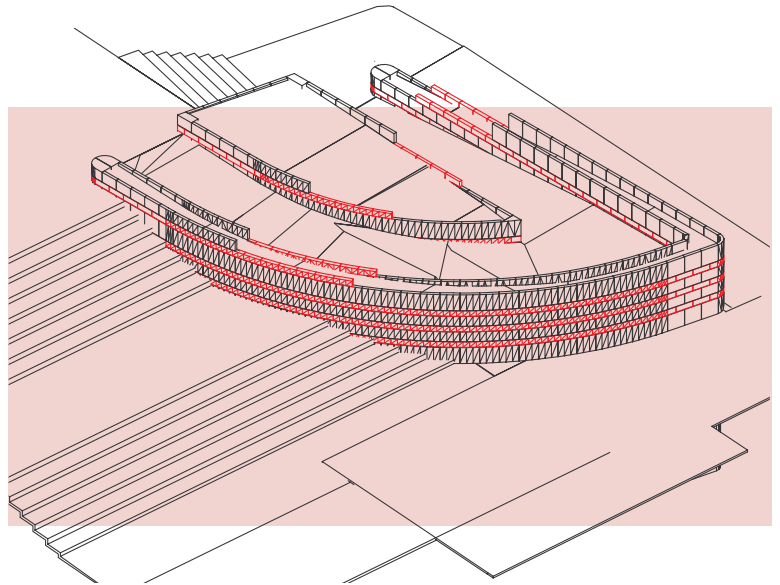
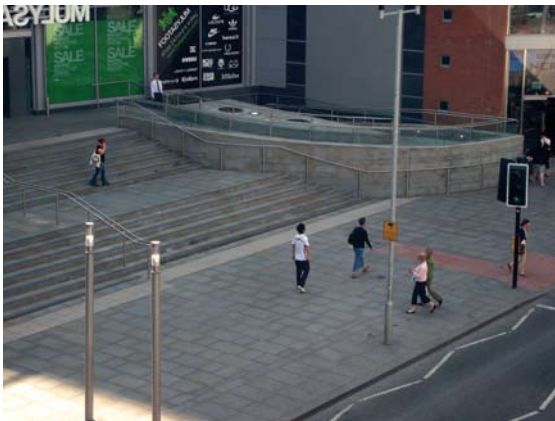

Church Street / Lord Street Liverpool

Church Street and Lord Street form the main shopping area in Liverpool. As one of the most used areas of the city and one of the busiest shopping streets in the country, a refurbishment was always going to be logistically difficult to minimise any disruption. To keep the street functioning for shoppers, shopkeepers and delivery vehicles it was decided that the scheme would be constructed in 17 predefined irregular shaped areas.

Marshalls worked with the contractor to break down the individual areas and specific quantities of the different items. This would be vital to deliver only what was required for each phase and in sequence of requirement, as space for stock on site was minimal. Close liaison with the contractor allowed Marshalls to deliver mixed loads of products to keep construction progress smooth through each area.

Town and city centre street refurbishments are notoriously difficult and contain many unforeseen elements which make a steady flow of materials to site very difficult to maintain. Contractors need to be able to take materials as the scheme allows and not to a predetermined schedule. It is therefore not uncommon for the largest schemes like this one to attract storage costs for materials of up to 10-20% of the costs of the materials.

Marshalls also agreed to ship and stock the entire materials required for the scheme at the start of the contract to allow for any potential changes of programme or working areas. All the materials were stored at no charge to the contractor. Very early morning timed deliveries allowed the materials to be dropped at several points along the site as required by the contractor, without disruption to other users of the street.

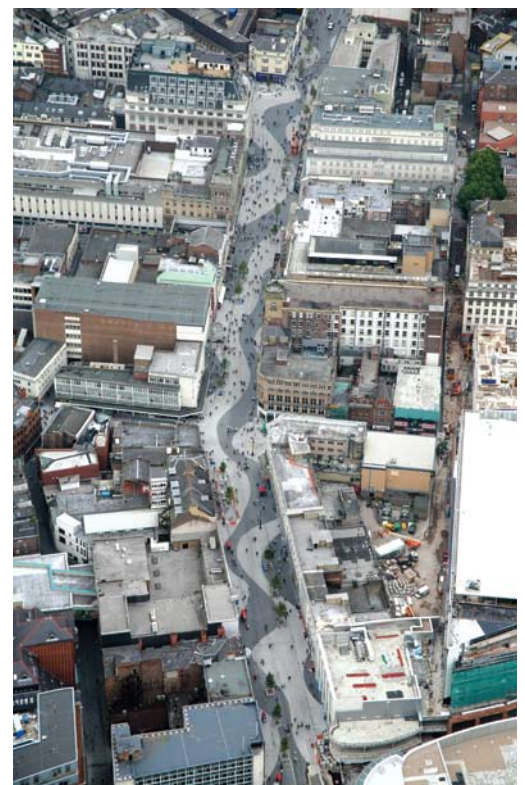

Chepstow

The historic town of Chepstow wanted to create a focal point for their square which had to accommodate large changes in topography across the area. The resulting design was this stunning interlocking sequence of circular turrets and redoubts which also cleverly allows the flow of movement through the centre of the structure. Ornately carved to reflect the various trades which had and do bring prosperity to the area, this beautiful structure is both stunning and unique.

Marshalls modelled the structure in 3-D to assess the more general requirements and to be able to produce individual component drawings for the production of this completely bespoke structure. The results are truly stunning.

