

ITEM NAME	ITEM CODE
Verso 600 - Complete - Silver Grey	VR-SE-00008
Verso 600 Complete - Escofet Grey	VR-SE-00012
Verso 600 - Complete - Anthracite	VR-SE-00016

**PRODUCT SPECIFICATION**

**MATERIAL:**  
Concrete

**FINISH:**  
Silver Grey

**FIXING TYPE:**  
Subsurface Mount

**APPROX WEIGHT:**  
Block - 520.1 kg

**FOUNDATIONS:**  
Concrete grade C16/20 mass fill **600 x 600 x 250**.

Ground to be flat and level.  
Ensure ground has sufficient load bearing capability to support the weight of the product. Where adverse site conditions are met professional advice to be sought.

- INSTALLATION:**
- Excavate suitable foundation as shown.
  - Cast concrete C16/20 foundation or similar.
  - Allow foundations to cure.
  - Attach M30 Lifting eyes (1 off).
  - Lower concrete block onto foundation.
  - Remove Lifting eyes and fit lifting point plugs (1 off).

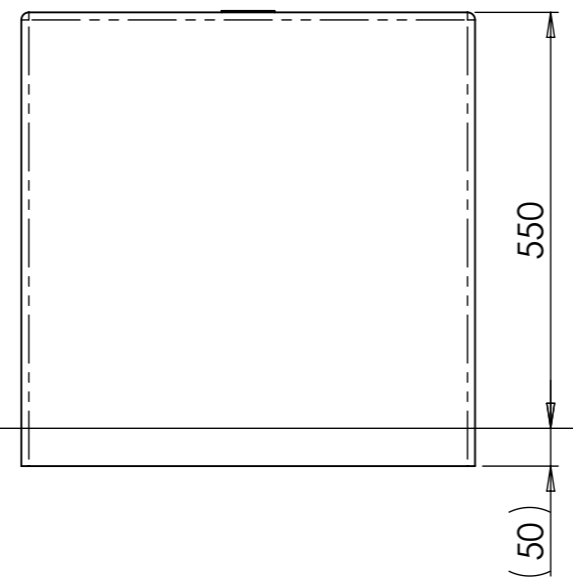
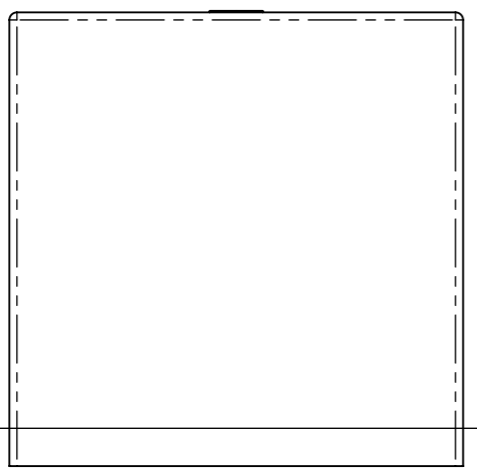
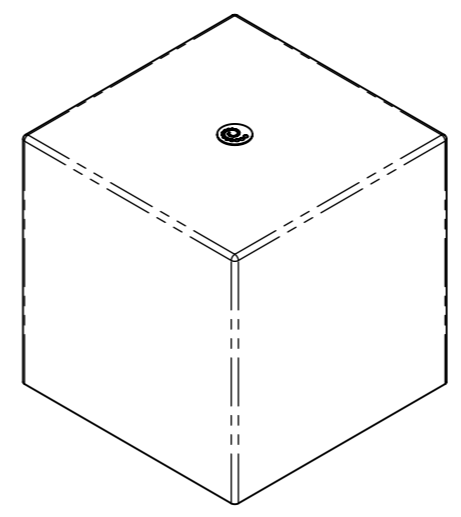
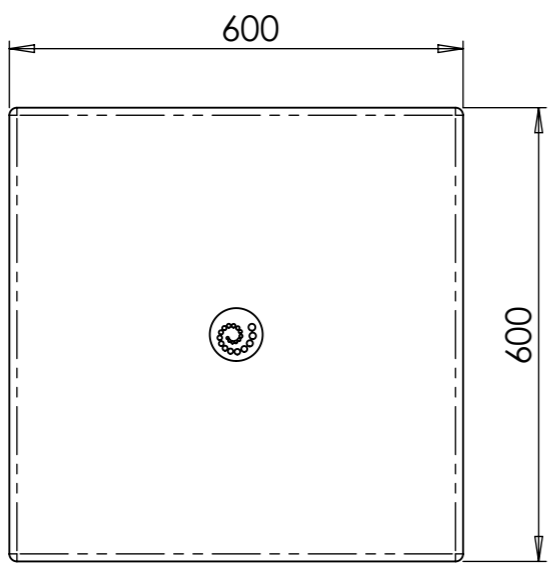

FGL

FGL

For operation and maintenance please refer to the **Marshalls Street Furniture Maintenance Guide**.

Unless otherwise stated: All Dimensions are in Millimetres  
Marshalls PLC reserves the right to change the specifications of any product detailed without prior notice.

Rev	Units	Revision Notes	ER No.	Date
A	HP	1st Release		20/07/2021

**Title:**  
Verso 600 Block - Complete

**Drawing No:**  
**PS-VR-SE-00008**

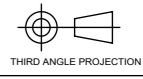

**Marshalls**  
Premier Way,  
Lowfields Business Park,  
Elland, Halifax,  
West Yorks, HX5 9HT

TEL: 0870 600 2426  
EMAIL: mst.sales@marshalls.co.uk  
www.marshalls.co.uk/commercial

**DRAWN BY:** HP      **DATE:** 20/07/2021

**DO NOT SCALE DRAWING**      **REVISION:** [A]

**SCALE:** 1:10@A3      **SHEET:** 1 of 2